

ZOOM 10 - ZM2XX

IP rated projector

design Lapo Grassellini

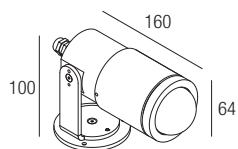

I INFORMAZIONI SULLA RIMOZIONE DELLE UNITÀ DI ALIMENTAZIONE SEPARATA DAL PRODOTTO CONTENITORE A FINE VITA

GB INFORMATION ON REMOVAL OF SEPARATE CONTROL GEAR FROM CONTAINING PRODUCT AT END OF LIFE

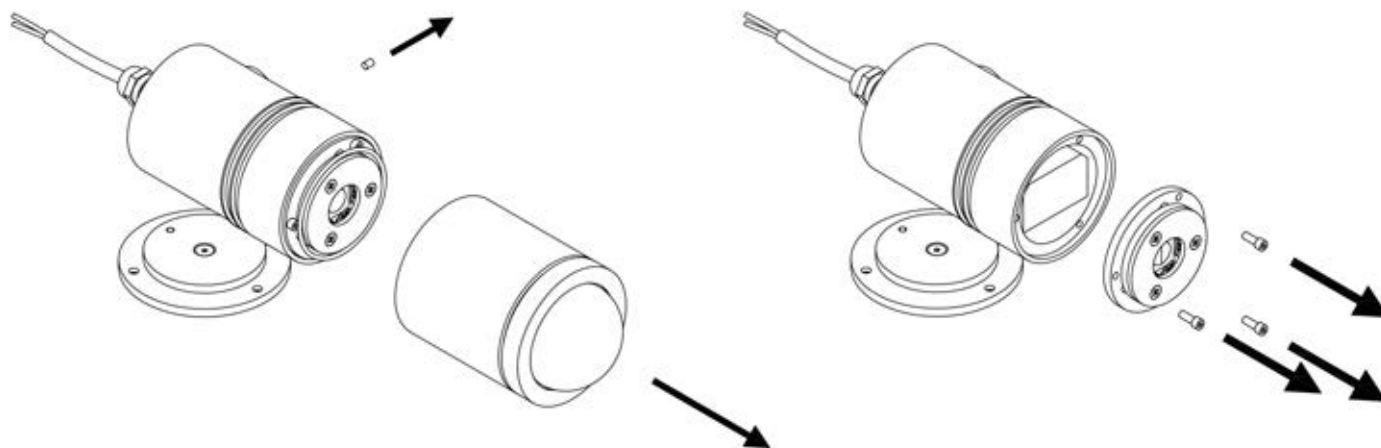

1

I Svitare il grano e rimuovere la parte frontale.
GB Unscrew the screw and remove the front part.

2

I Svitare le viti e rimuovere la parte frontale.
GB Unscrew the screws and remove the front part.



3

I Rimuovere l'unità di alimentazione.
GB Remove control gear.

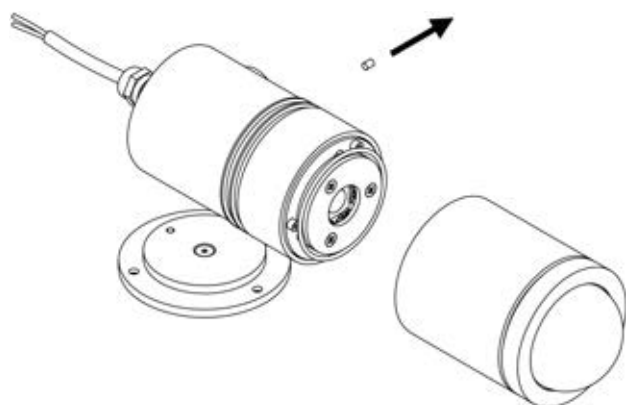

1

I Svitare il grano e rimuovere la parte frontale.
GB Unscrew the screw and remove the front part.

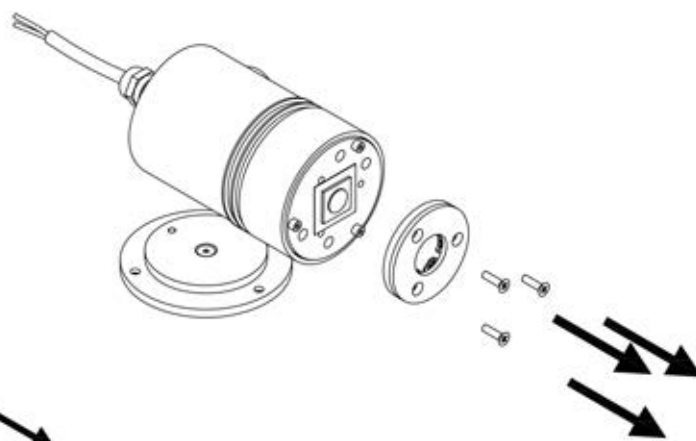

2

I Svitare le viti e rimuovere il fermalente.
GB Unscrew the screws and remove the locking ring.

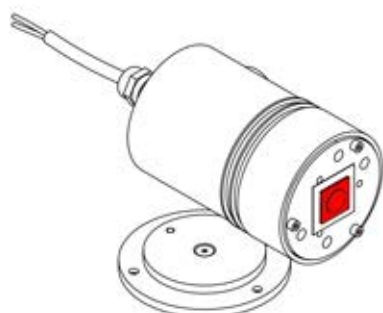

3

I Rimuovere la sorgente luminosa.
GB Remove light source.