

## SASHA 130 DISPLAY - SD13XXXX

Surface projectors

design Lapo Grassellini

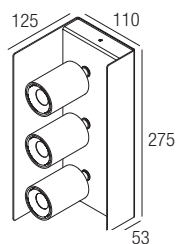

I ISTRUZIONI PER LE AUTORITÀ PREPOSTE ALLA SORVEGLIANZA DEL MERCATO SULLA RIMOZIONE DELLE UNITÀ DI ALIMENTAZIONE SEPARATA

GB INFORMATION FOR MARKET SURVEILLANCE AUTHORITIES ON REMOVAL OF SEPARATE CONTROL GEAR

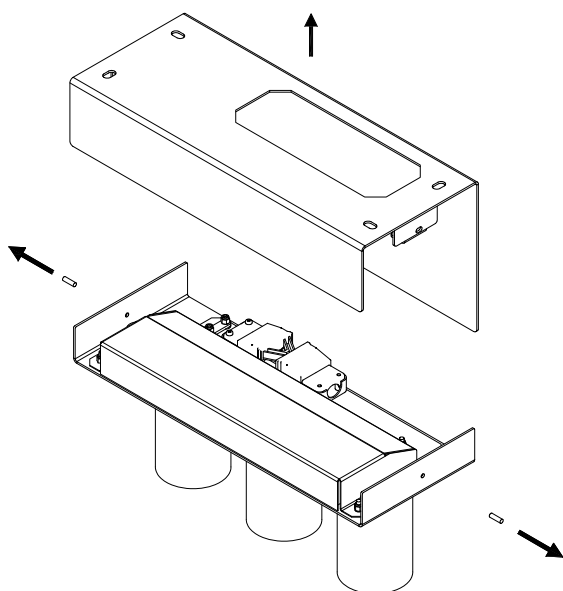

1

I Svitare i grani e rimuovere la lamiera superiore.  
GB Unscrew the screws and remove the metal sheet on the top.

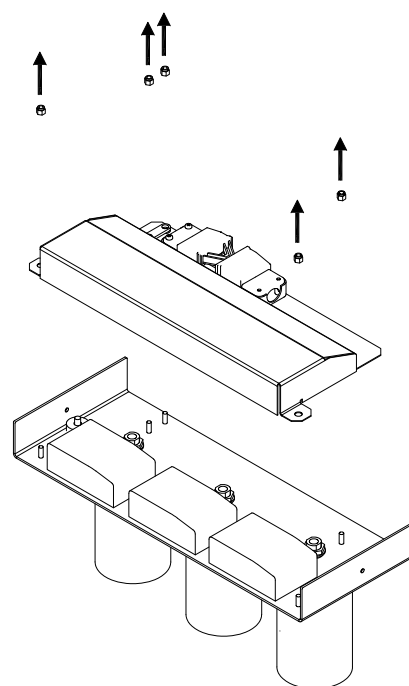

2

I Svitare le i dadi e rimuovere la lamiera.  
GB Unscrew the nuts and remove the metal sheet.

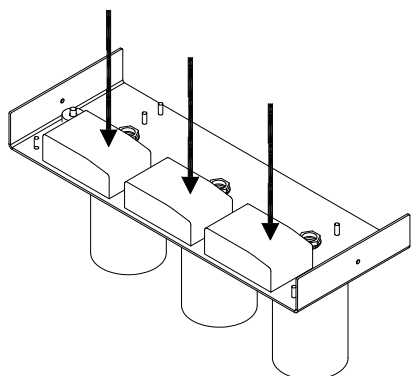

3

I Drivers ispezionabili.  
GB Examinable drivers.

I **NOTA** - Ripetere i passaggi 4-5-6-7 per ciascuna parte frontale del prodotto.

GB **NOTE** - Repeat steps 4-5-6-7 for each front part of the product.

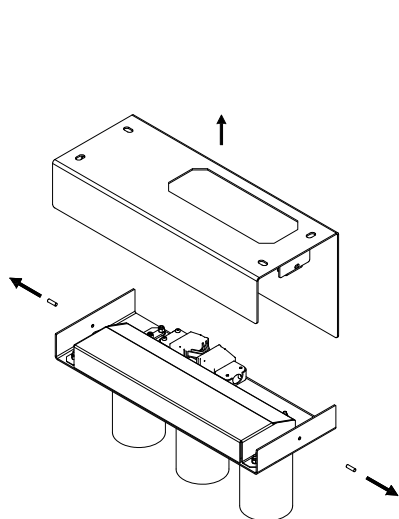

**1**

I Svitare i grani e rimuovere la lamiera superiore.

GB Unscrew the screws and remove the metal sheet on the top.

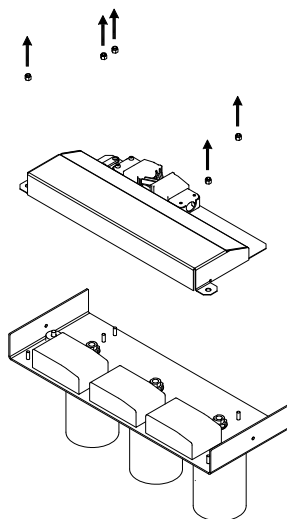

**2**

I Svitare il dadi e rimuovere la lamiera.

GB Unscrew the nuts and remove the metal sheet.

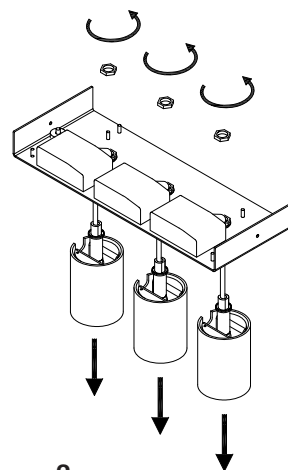

**3**

I Svitare i dadi e rimuovere le parti frontale.

GB Unscrew the nuts and remove the front parts.

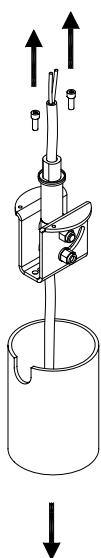

**4**

I Svitare le viti e rimuovere i componenti interni.

GB Unscrew the screws and remove the inner components.

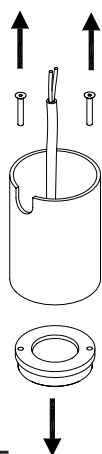

**5**

I Svitare le viti e rimuovere l'anello frontale.

GB Unscrew the screws and remove the front ring.

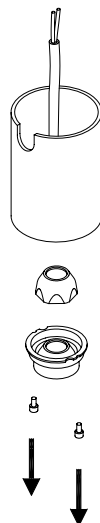

**6**

I Svitare le viti e rimuovere l'ottica.

GB Unscrew the screws and remove the optic.

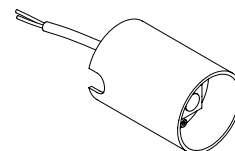

**7**

I Sorgente luminosa ispezionabile.

GB Examinaable light source.