

MILO X130 - MLX13XXXX

Trimless downlights

design Lapo Grassellini

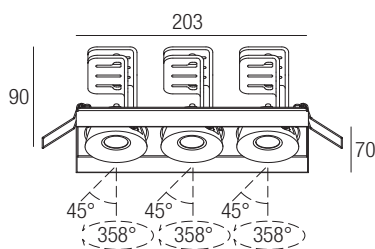

I ISTRUZIONI PER LE AUTORITÀ PREPOSTE ALLA SORVEGLIANZA DEL MERCATO SULLA RIMOZIONE DELLA SORGENTE LUMINOSA E DELLE UNITÀ DI ALIMENTAZIONE SEPARATA
GB INFORMATION FOR MARKET SURVEILLANCE AUTHORITIES ON REMOVAL OF LIGHT SOURCE AND SEPARATE CONTROL GEAR

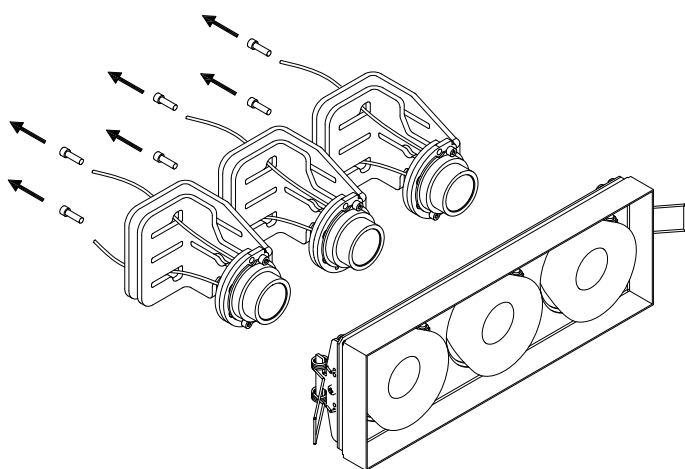

1

I Svitare le viti e rimuovere la parte frontale.
GB Unscrew the screws and remove the front part.

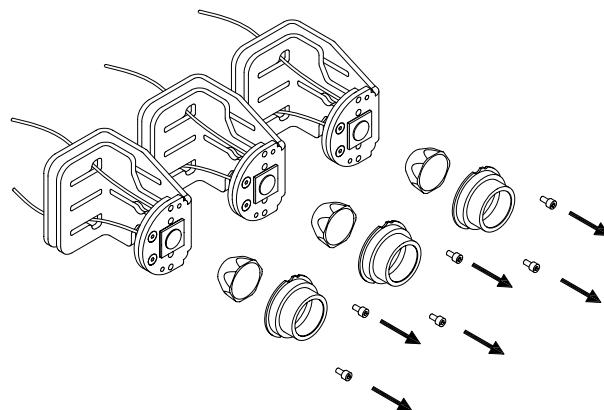

2

I Svitare le viti e rimuovere l'ottica.
GB Unscrew the screws and remove the optic.

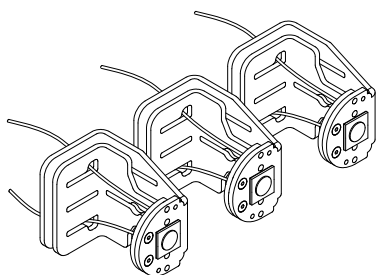

3

I Sorgente luminosa ispezionabile.
GB Examinable light source.