

LEONARD 72 - LN72XXX

MAGGY 72 - Adjustable Module

design Lapo Grassellini

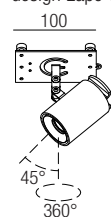

I ISTRUZIONI PER LE AUTORITÀ PREPOSTE ALLA SORVEGLIANZA DEL MERCATO SULLA RIMOZIONE DELLA SORGENTE LUMINOSA E DELLE UNITÀ DI ALIMENTAZIONE SEPARATA
GB INFORMATION FOR MARKET SURVEILLANCE AUTHORITIES ON REMOVAL OF LIGHT SOURCE AND SEPARATE CONTROL GEAR

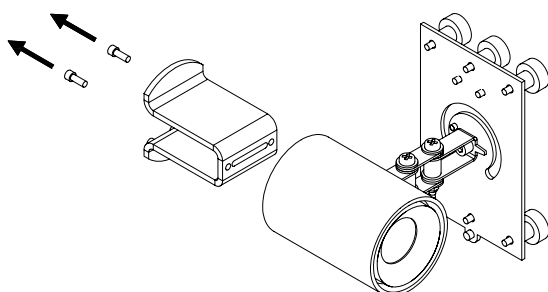

1

I Svitare le viti e rimuovere la lamiera posteriore.
GB Unscrew the screws and remove the sheet metal on the back side.

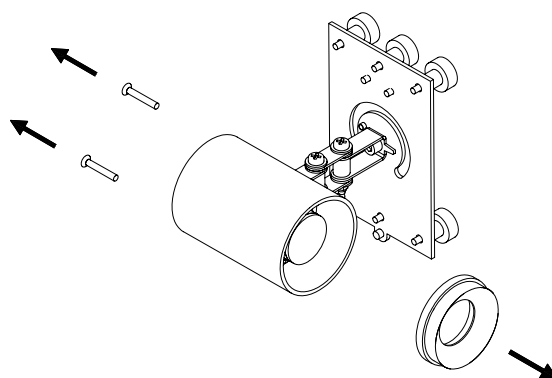

2

I Svitare le viti e rimuovere l'anello frontale.
GB Unscrew the screws and remove the front ring.

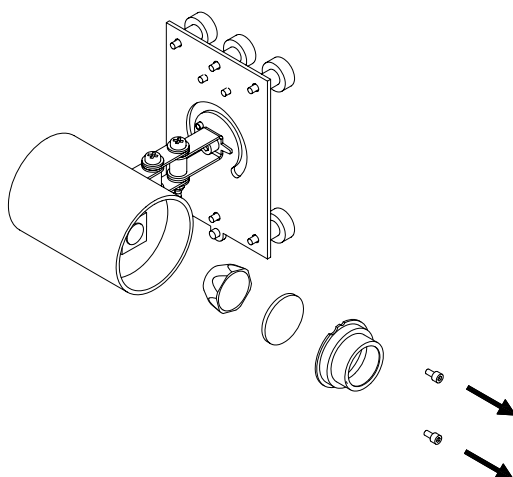

3

I Svitare le viti e rimuovere l'ottica.
GB Unscrew the screws and remove the optic.

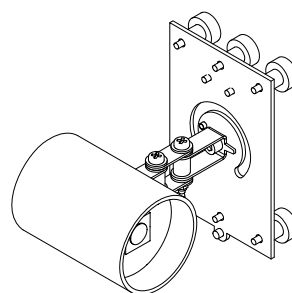

4

I Sorgente luminosa ispezionabile.
GB Examined light source.