

KELLER D - KE2XXXXX

Ceiling wall mounted luminaire

design Roberto Mantovani

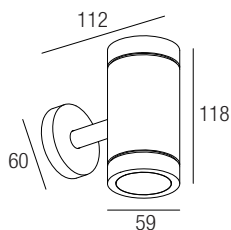

I ISTRUZIONI PER LE AUTORITÀ PREPOSTE ALLA SORVEGLIANZA DEL MERCATO SULLA RIMOZIONE DELLA SORGENTE LUMINOSA E DELLE UNITÀ DI ALIMENTAZIONE SEPARATA
GB INFORMATION FOR MARKET SURVEILLANCE AUTHORITIES ON REMOVAL OF LIGHT SOURCE AND SEPARATE CONTROL GEAR

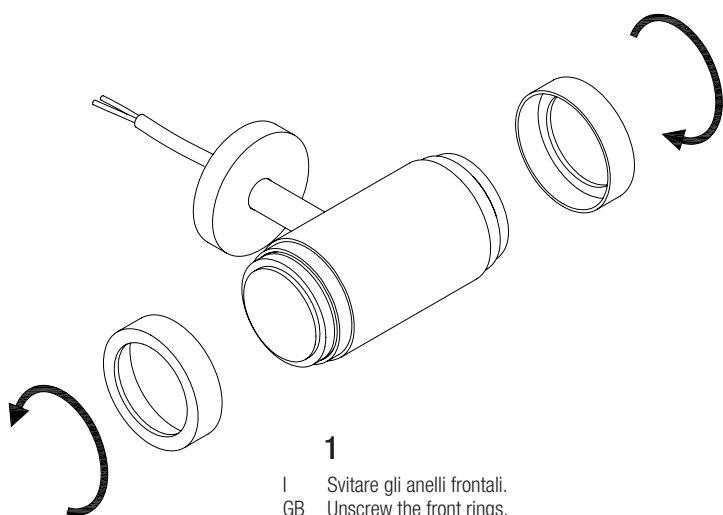

1
I Svitare gli anelli frontali.
GB Unscrew the front rings.

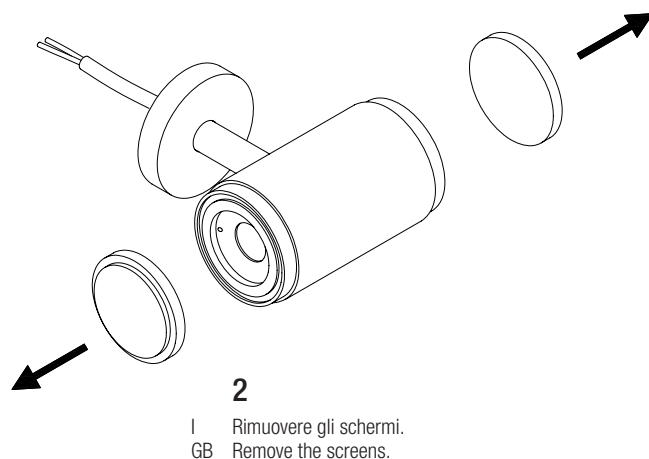

2
I Rimuovere gli schermi.
GB Remove the screens.

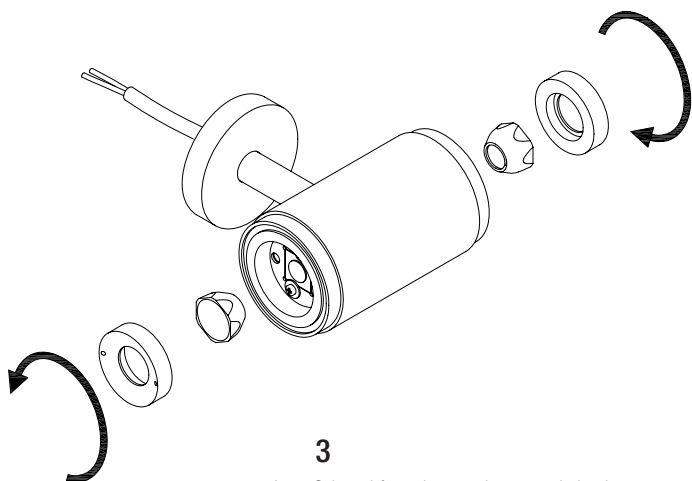

3
I Svitare i fermalente e rimuovere le lenti.
GB Unscrew the locking rings and remove the optics.

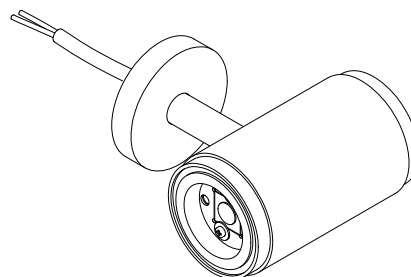

4
I Sorgente luminosa ispezionabile.
GB Examinable light source.