

## JOS PS6 - JSPS6XXX

Pendants

design Roberto Mantovani

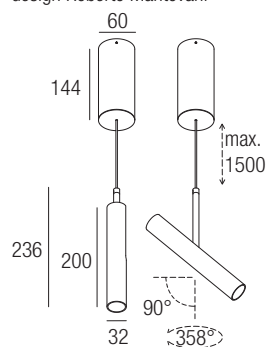

I INFORMAZIONI SULLA RIMOZIONE DELLE UNITÀ DI ALIMENTAZIONE SEPARATA DAL PRODOTTO CONTENITORE A FINE VITA

GB INFORMATION ON REMOVAL OF SEPARATE CONTROL GEAR FROM CONTAINING PRODUCT AT END OF LIFE

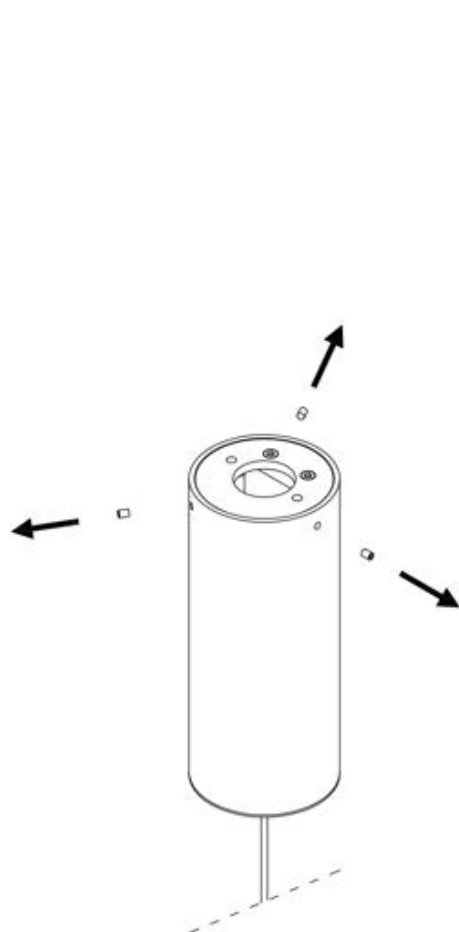

1

I Svitare i grani.  
GB Unscrew the screws.

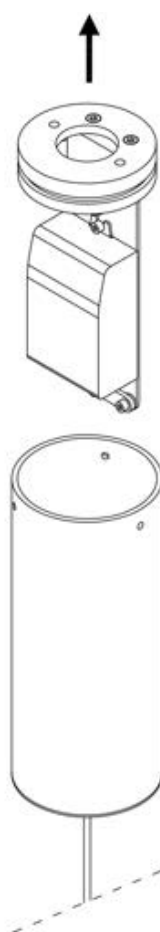

2

I Rimuovere i componenti interni.  
GB Remove the inner components.

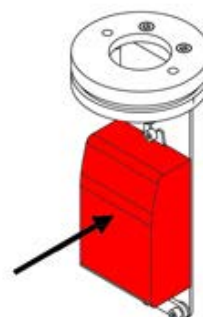

3

I Rimuovere l'unità di alimentazione.  
GB Remove control gear.

I INFORMAZIONI SULLA RIMOZIONE DELLA SORGENTE LUMINOSA DAL PRODOTTO CONTENITORE A FINE VITA

GB INFORMATION ON REMOVAL OF LIGHT SOURCE FROM CONTAINING PRODUCT AT END OF LIFE

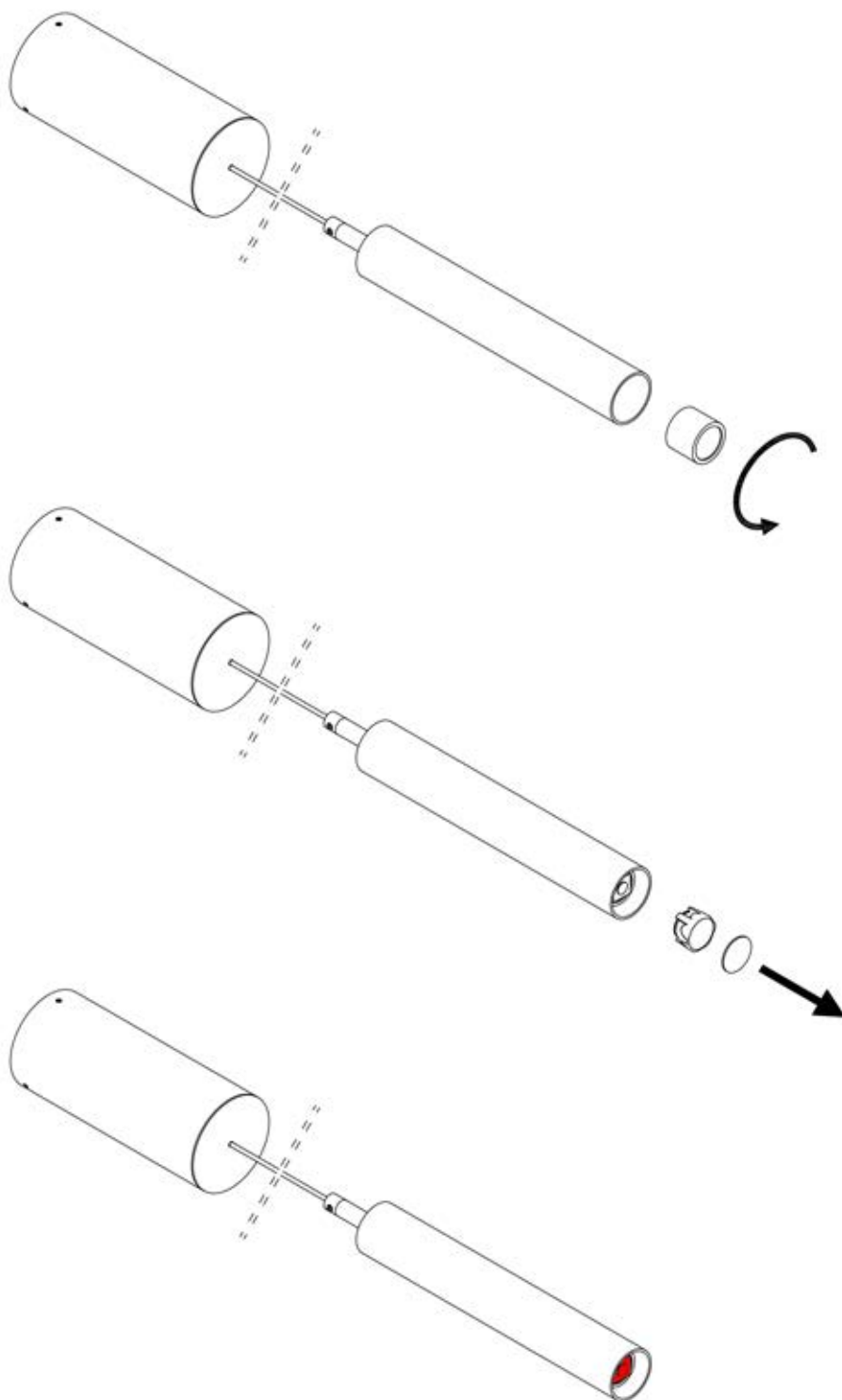

**1**

I Svitare l'anello frontale.  
GB Unscrew the front ring.

**2**

I Rimuovere l'ottica.  
GB Remove the optic.

**3**

I Rimuovere la sorgente luminosa.  
GB Remove light source.