

GAGARIN PS6 - GPS6XXX

Pendants

design Roberto Mantovani

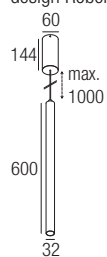

I INFORMAZIONI SULLA RIMOZIONE DELLE UNITÀ DI ALIMENTAZIONE SEPARATA DAL PRODOTTO CONTENITORE A FINE VITA

GB INFORMATION ON REMOVAL OF SEPARATE CONTROL GEAR FROM CONTAINING PRODUCT AT END OF LIFE

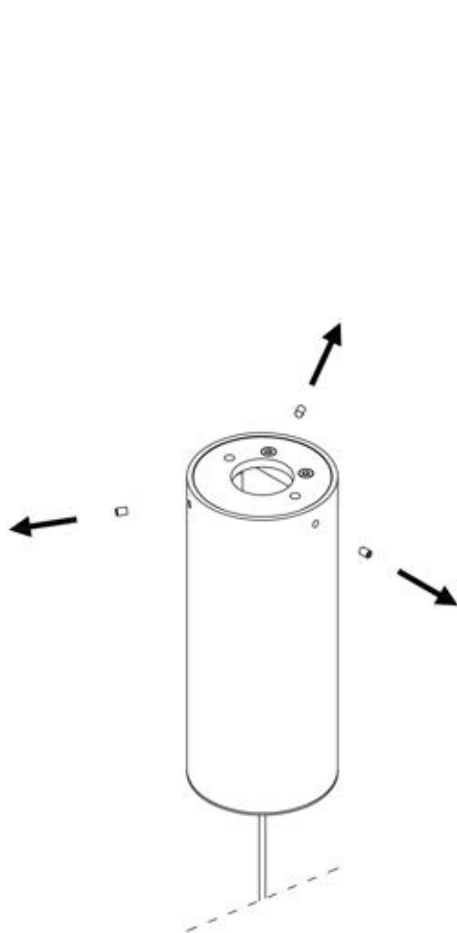

1

I Svitare i grani.
GB Unscrew the screws.

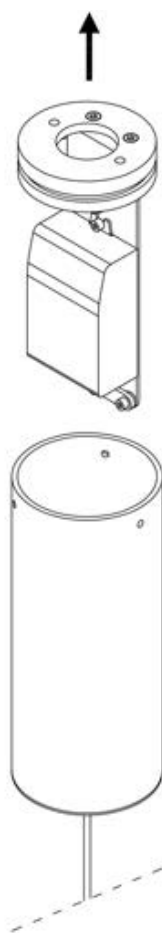

2

I Rimuovere i componenti interni.
GB Remove the inner components.

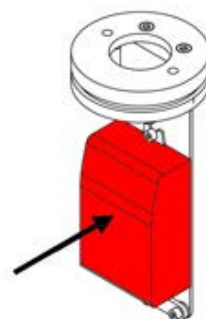

3

I Rimuovere l'unità di alimentazione.
GB Remove control gear.

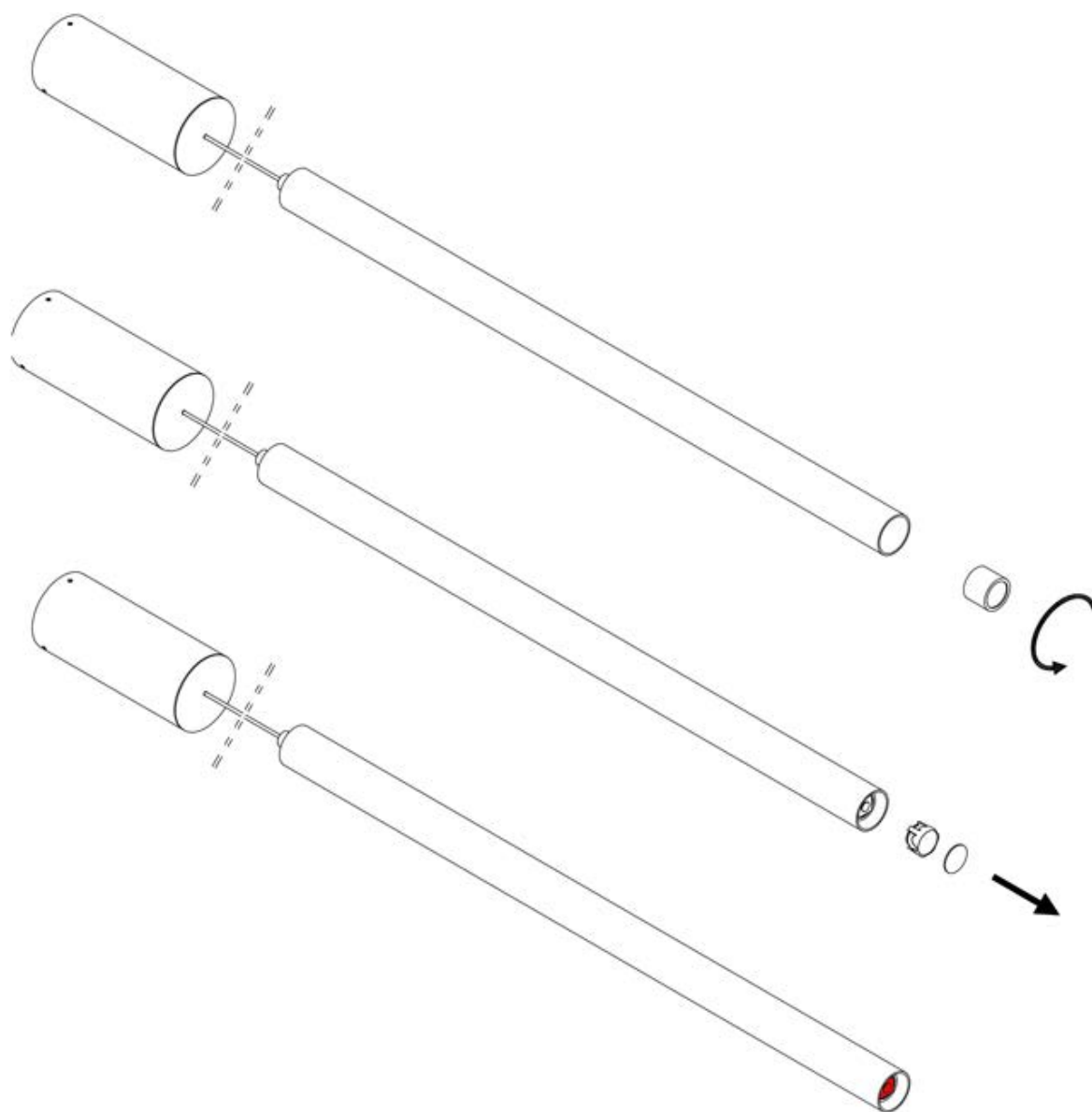

1
I Svitare l'anello frontale.
GB Unscrew the front ring.

2
I Rimuovere l'ottica.
GB Remove the optic.

3
I Rimuovere la sorgente luminosa.
GB Remove light source.