

## DAVID 36

Maggy 36 - Fixed module

design Lapo Grassellini



The David high performance, fixed module, remaining entirely within the structure, has negligible visual impact.

Il modulo David, fisso, rimane interamente all'interno della struttura, con un'alta prestazione ed un impatto visivo nullo.

Le module David, fixe, reste entièrement à l'intérieur de la structure, avec une prestation élevée et un impact visuel nul.

Das feststehende Modul David bleibt vollständig im System der Struktur, mit hoher Leistung und nicht sichtbar.

El módulo David, fijo, queda totalmente englobado dentro de la estructura, con una alta prestación y un impacto visual nulo.

CE  IP20 made in Italy

### Supply current

250mA (V, 36V)

### Power

10W

### CRI

85-93

### 2-Step MacAdam

### Dimensions

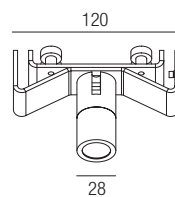

### Photometric diagrams

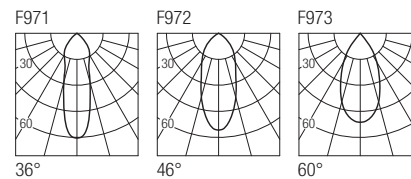

### CCT/CRI/Flux

|       | CRI85  | CRI93 |
|-------|--------|-------|
| 2700K | 890lm  | 840lm |
| 3000K | 1000lm | 930lm |
| 4000K | 1040lm | 960lm |

### Code construction

DA36 X X X

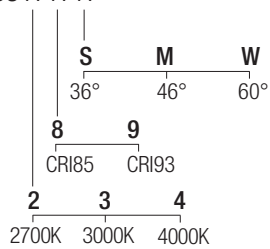

### Drivers 250mA

on/off

AL1025 (1) IP20

dimmmable

AL4030 (1) IP20 0/1..10V

AL4031 (1) IP20 DALI

AL4032 (1) IP20 IGBT-TRIAC