

BULL 10 FOCUS - BF1XXX

Projector for 230VAC track
design Lapo Grassellini

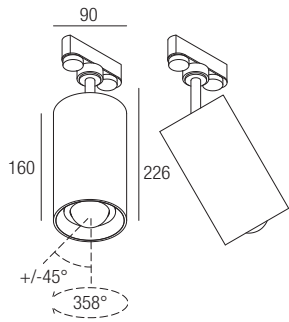

I ISTRUZIONI PER LE AUTORITÀ PREPOSTE ALLA SORVEGLIANZA DEL MERCATO SULLA RIMOZIONE DELLE UNITÀ DI ALIMENTAZIONE SEPARATA
GB INFORMATION FOR MARKET SORVEILLANCE AUTHORITIES ON REMOVAL OF SEPARATE CONTROL GEAR

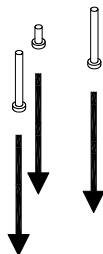
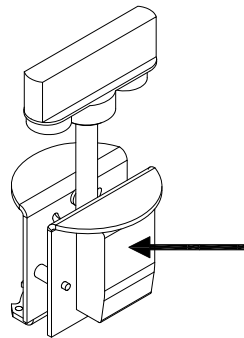
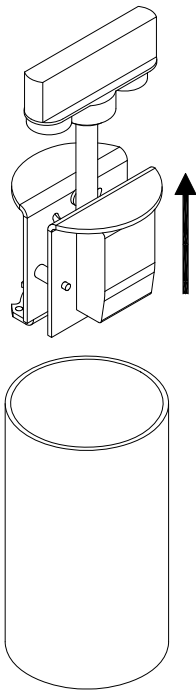

1

I Svitare le viti e rimuovere la parte superiore.
GB Unscrew the screws and remove superior part.

2

I Driver ispezionabile.
GB Examinable driver.

I ISTRUZIONI PER LE AUTORITÀ PREPOSTE ALLA SORVEGLIANZA DEL MERCATO SULLA RIMOZIONE DELLA SORGENTE LUMINOSA

GB INFORMATION FOR MARKET SURVEILLANCE AUTHORITIES ON REMOVAL OF LIGHT SOURCE

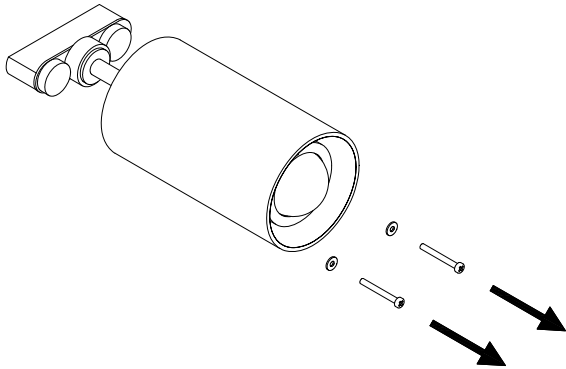

1

I Svitare le viti.
GB Unscrew the screws.

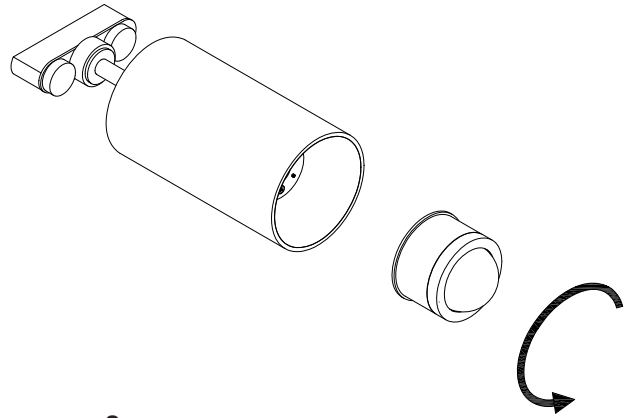

2

I Svitare la parte frontale.
GB Unscrew the front part.

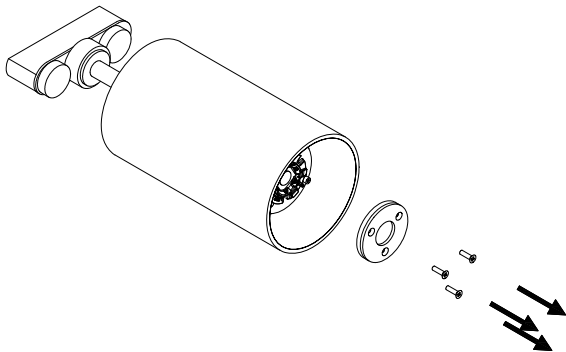

1

I Svitare le viti e rimuovere l'anello.
GB Unscrew the screws and remove the ring.

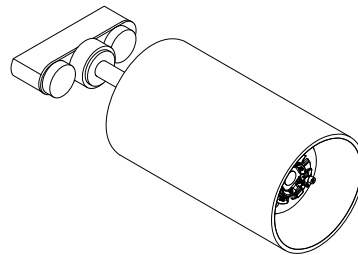

2

I Sorgente luminosa ispezionabile.
GB Examined light source.